

Smart Keybox User Guide



corplock.com.au

Installation

Mount it on surface if needed

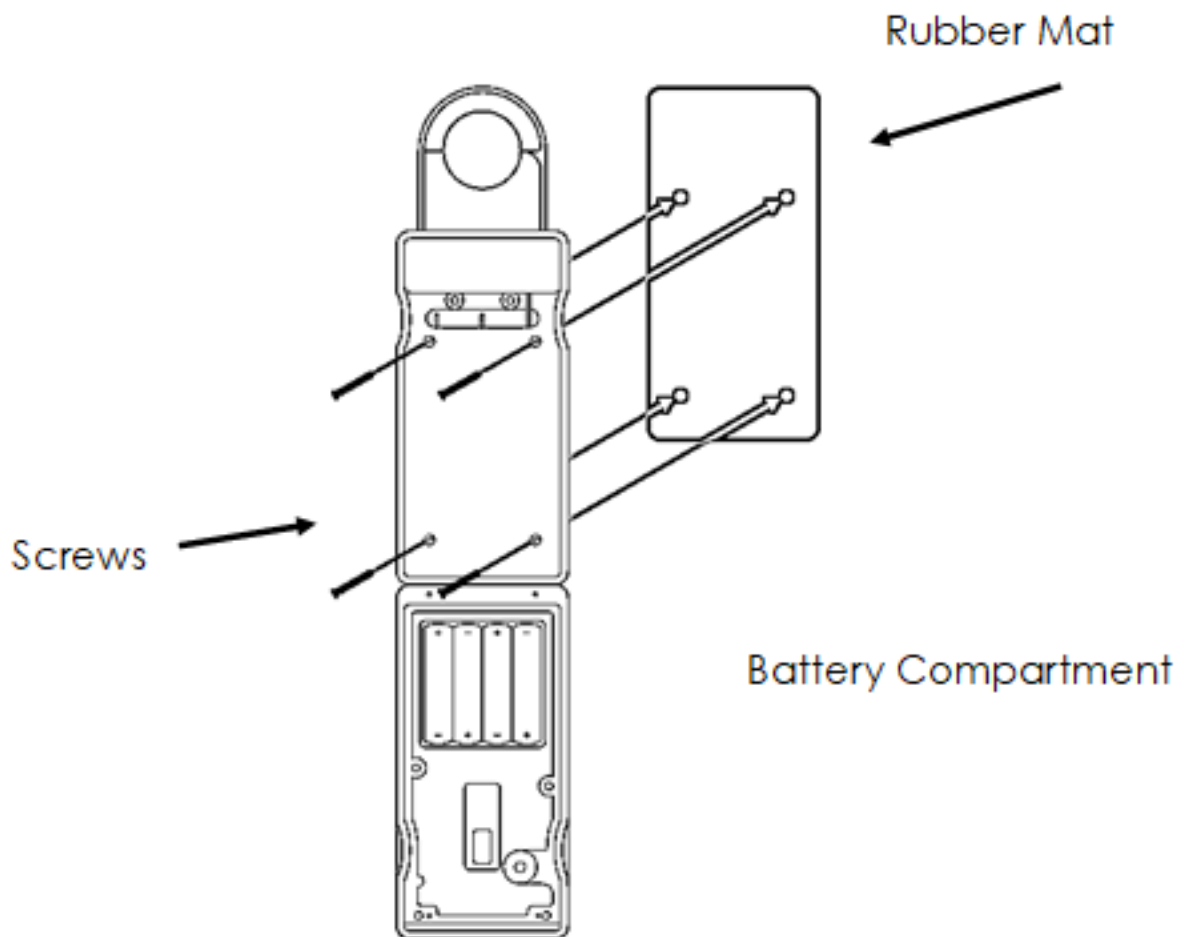

Buckle Usage

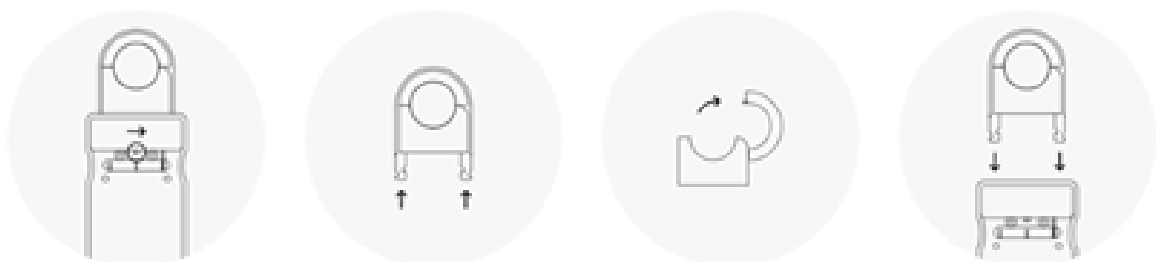

Quick Start Guide

Factory Mode (Working Without App)

1. Open the battery cover with the provided screwdriver and insert 4 AAA lithium batteries as described in 'Battery Installation'.
2. Touch the keypad to wake up the key box, enter the default password 134 and end with the 'unlock button' in the bottom right hand corner.

Note

1. The batteries are not included in the product.
2. The 'unlock button' in the bottom right hand corner is not part of the password. It is required as confirmation every time a passcode is entered for entry.

Read these notes before using

1. In 'Factory Mode' (Before App Pairing), the default keypad password is 1234. Once the lock is paired in the TTLock App, the default password becomes invalid and you will get a new Admin password in 'Lock Settings' in App. If you delete the lock from the App, the password 1234 becomes valid again.
2. Every time the key box is closed, it will automatically lock itself.
3. To control the key box more conveniently, like unlocking via Bluetooth, creating and sharing passwords, you can install TTLock App through Apple Appstore, Google Play or the QR codes below.
4. The key box is controlled via the phone via Bluetooth. While operating please enable phone Bluetooth and make sure that the key box is within the range of the phone Bluetooth (allowing for different circumstances, the suggested distance is less than 2 meters).



Apple App Store



Google Play Store

Components Overview



Keysafe

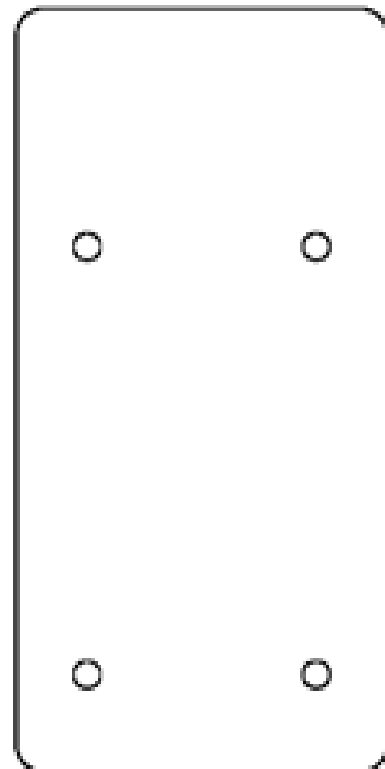

Rubber Mount

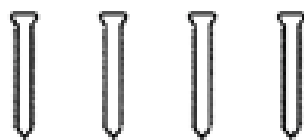

Screws

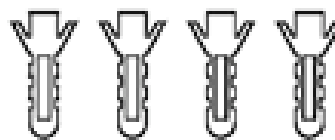

Screws Anchors



Waterproof Rubber Rings

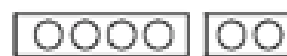

Nylon Rubber Stoppers



Screwdriver

Specifications

Model: CLSEK1

Product Dimensions: 195(h) x 66(w) x 42(l)mm

Inner Space of Shackle Dimensions: 60(w) x 35(l)mm

Material: Zinc Alloy, Steel, Plastic, Silicon, Rubber

Weight: 1.2kg

Wireless Protocol: BLE 4.1

Batteries: 4 x AAA (Not Included)

Unlock Mechanism: Bluetooth, Pin Code, Smart Phone

Water & Dust Proof: IP66

Drop Test: 1 Meter

Working Temperature: -40 ~ 55 degrees celcius



SECESAFE

SMART LOCKING



How to Use

Pair the Keybox in App

In the homepage of TTLock App, click the menu bar in the top left corner > select the '+' 'Add Lock' > Select 'All Locks' > When the lock appears press the '+' symbol >

Follow the instructions prompted with to complete the pairing.

If the pairing is unsuccessful, you can take the following steps:

- restart Bluetooth and internet connection on your phone;
- restart the TTLock App on your phone;
- pair the Keybox again.

If it still doesn't work and the lock has been previously paired, ensure the previous owner has deleted the lock in the App settings.

If the lock is brand new you can press the reset button until a beep sound indicates the box has been reset. The reset button is located under the battery cover.

Unlock by Admin Password

Admin password is generated after pairing successfully, which can be used to unlock via the keypad. If the number you entered is incorrect, you can press the icon in the bottom right corner to re-enter. Or you can enter the Decoy code to unlock it. For details about the Decoy Code, please refer to the security section of this manual.

Note

1. If you want to modify it, you can follow below:
Lock page in TTLock App > Settings > Admin Password > Enter your Password > Ensure you select permanent or timed > Save.

2. If you enter the wrong password continuously, for more than 5 times the keypad will be disabled for 5 minutes. You can enable it immediately by unlocking via Bluetooth in the TTLock App or wait 5 minutes to enter the correct password again.

Unlock by Bluetooth Key

Turn on Bluetooth, make sure the phone is close to the Key Box, and unlock the Key Box by clicking the UNLOCK button on the App.

How to Use

Sharing Password

It is a 6-9 digit password that can be set to permanent or timed according to the admin. The password can be created in the TTLock App by the administrator. You can create and share passwords by the following steps:

Lock page in TTLock App > Passwords > Click the Button three dots in the top right hand corner > select 'generate passcode > follow the instructions on screen > Share

Note

1. One-time password is valid within 6 hours after creation. Permanent/Cyclic passwords must be activated within 24 hours after creation. Period password must be activated within 24 hours from Start Time.

Sharing Bluetooth Key

Lock owner can authorize other TTLock users to unlock door via Bluetooth eKeys in the App. You can share Bluetooth keys by the following steps: Go to lock page in App > eKeys > Select time period and user to send key to > Send

Unlocking Records

You can view the operation records of the key box. And the operation will be recorded only when the key box is unlocked successfully. You can view and synchronize the records by the following steps:

Lock Page in TTLock App > Records

You can synchronize the unlocking records via Bluetooth near the key box.

Security

Automatic Locking

If the key box is unlocked but remains closed, it will automatically lock itself in 30 seconds.

Security Alarm

If the key box is not closed properly it will beep to indicate it is not secure.

Decoy Code

You can enter up to 10 digits before or after the correct password to prevent someone from breaching your security and seeing your passcode. For example: You can unlock the key box by entering 12315892314361, where 58923 is the correct password.

The maximum length for one attempt is 16 digits. This feature is enabled after pairing the key box with the TTLock app.

Emergency Jump Start

The batteries can support up to 10,000 operations of unlocking/locking (approx. 12 months).

If the batteries power is drained, an external 9 Volt battery can be used to provide emergency power.

The 2 pins of the battery must be aligned with the 2 pins at the bottom of the key box as shown below.

Stay Connected



[corporate_locksmiths](#)



[Cloud Lock](#)



sales@corplock.com.au



www.corplock.com.au